

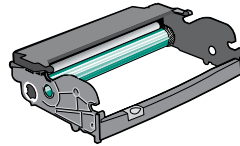

Replacing the photoconductor kit



- 1 Turn the printer off.
- 2 Open the front door by pressing the button on the left side of the printer and lowering the front door.
- 3 Pull the photoconductor kit and toner cartridge out of the printer as a unit by pulling on the toner cartridge handle.

Note: The photoconductor kit and toner cartridge form a unit.

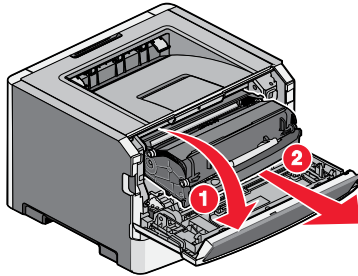

Place the unit on a flat, clean surface.

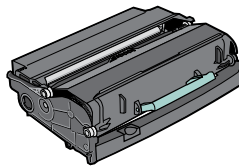

- 4 Press the button on the base of the photoconductor kit. Pull the toner cartridge up and out using the handle.

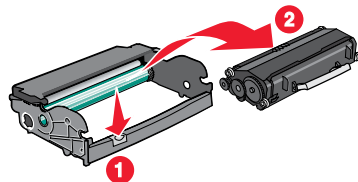

- 5 Unpack the new photoconductor kit.

Warning—Potential Damage: Be careful not to touch the photoconductor drum. Doing so may affect the print quality of future print jobs.

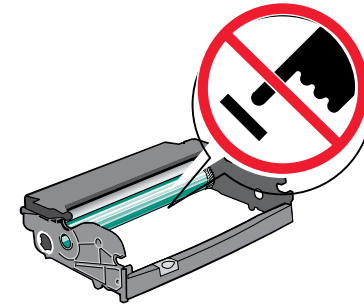

- 6 Insert the toner cartridge into the photoconductor kit by aligning the rollers on the toner cartridge with the tracks. Push the toner cartridge until it *clicks* into place.

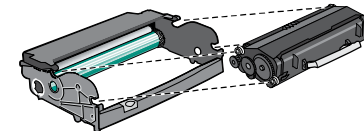

- 7 Install the unit into the printer by aligning the arrows on the guides of the unit with the arrows in the printer. Push the unit as far as it will go.

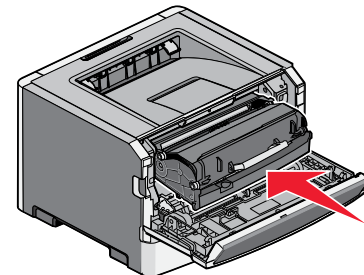

- 8 After you replace the photoconductor kit, reset the photoconductor counter.

To reset the photoconductor counter, open the front door, press and hold **X** until **Resetting PC Counter** appears. The power light blinks, and the printer beeps.

Warning—Potential Damage: Resetting the photoconductor counter without replacing the photoconductor may damage your printer and void your warranty.

- 9 Close the front door.

